

Initial S™ EVO: Single use sterile kit for Ø3.5 mm chamfered head screws

Initial S™ EVO - Kit content

Indication for use:

Initial S is part of the Foot and Hand Motion range. The implants of the Foot and Hand Motion range are intended for the fixation of bone fractures and osteotomies and for arthrodeses of foot and hand in adults.

Contraindications:

- Pregnancy.
- Acute or chronic local or systemic infections.
- Allergy to one of the materials used or sensitivity to foreign bodies.

STERILE INSTRUMENTATION FOR Ø3.5 MM CHAMFERED HEAD SCREWS

Ref.	Description	Content	Qty
KIT-SCND3.5	Instrumentation kit for Ø3.5 mm chamfered cannulated screws	Ø2.5 mm quick coupling drill bit – cannula Ø1.5 mm – L110 mm	1
		3 in 1 instrument for Ø3.5 mm screws	1
		Pin Ø1.4 mm L150 mm	3
		5.8 mm single use handle	1

➤ For removal of the Ø3.5 mm screws, please use the T10 screwdriver (ANC1674).

Ø3.5 MM CHAMFERED HEAD SCREWS*

Ref.	Description
H1.5NT3.5L20D-ST	Ø3.5 mm chamfered head screw - cannula Ø1.5 - L20 mm - STERILE
H1.5NT3.5L22D-ST	Ø3.5 mm chamfered head screw - cannula Ø1.5 - L22 mm - STERILE
H1.5NT3.5L24D-ST	Ø3.5 mm chamfered head screw - cannula Ø1.5 - L24 mm - STERILE
H1.5NT3.5L26D-ST	Ø3.5 mm chamfered head screw - cannula Ø1.5 - L26 mm - STERILE
H1.5NT3.5L28D-ST	Ø3.5 mm chamfered head screw - cannula Ø1.5 - L28 mm - STERILE
H1.5NT3.5L30D-ST	Ø3.5 mm chamfered head screw - cannula Ø1.5 - L30 mm - STERILE
H1.5NT3.5L32D-ST	Ø3.5 mm chamfered head screw - cannula Ø1.5 - L32 mm - STERILE
H1.5NT3.5L34D-ST	Ø3.5 mm chamfered head screw - cannula Ø1.5 - L34 mm - STERILE
H1.5NT3.5L36D-ST	Ø3.5 mm chamfered head screw - cannula Ø1.5 - L36 mm - STERILE
H1.5NT3.5L38D-ST	Ø3.5 mm chamfered head screw - cannula Ø1.5 - L38 mm - STERILE
H1.5NT3.5L40D-ST	Ø3.5 mm chamfered head screw - cannula Ø1.5 - L40 mm - STERILE
H1.5NT3.5L42D-ST	Ø3.5 mm chamfered head screw - cannula Ø1.5 - L42 mm - STERILE
H1.5NT3.5L44D-ST	Ø3.5 mm chamfered head screw - cannula Ø1.5 - L44 mm - STERILE
H1.5NT3.5L46D-ST	Ø3.5 mm chamfered head screw - cannula Ø1.5 - L46 mm - STERILE
H1.5NT3.5L48D-ST	Ø3.5 mm chamfered head screw - cannula Ø1.5 - L48 mm - STERILE
H1.5NT3.5L50D-ST	Ø3.5 mm chamfered head screw - cannula Ø1.5 - L50 mm - STERILE
H1.5NT3.5L52D-ST	Ø3.5 mm chamfered head screw - cannula Ø1.5 - L52 mm - STERILE
H1.5NT3.5L54D-ST	Ø3.5 mm chamfered head screw - cannula Ø1.5 - L54 mm - STERILE
H1.5NT3.5L56D-ST	Ø3.5 mm chamfered head screw - cannula Ø1.5 - L56 mm - STERILE
H1.5NT3.5L58D-ST	Ø3.5 mm chamfered head screw - cannula Ø1.5 - L58 mm - STERILE
H1.5NT3.5L60D-ST	Ø3.5 mm chamfered head screw - cannula Ø1.5 - L60 mm - STERILE

*Screws available separately in sterile version (S-Box).

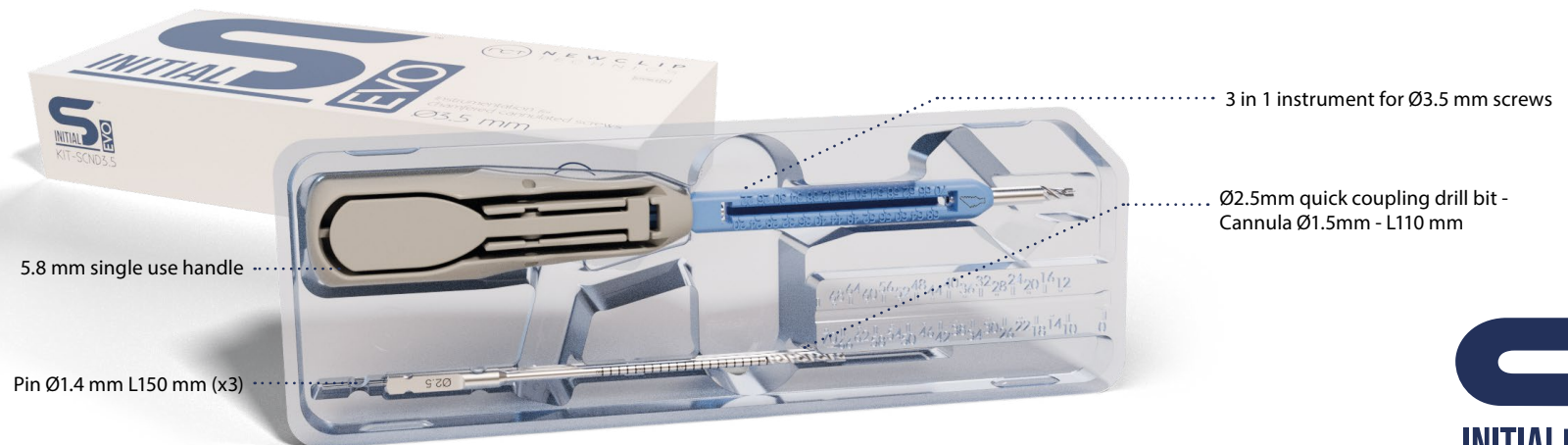

NEW CLIP
TECHNICS



Initial S™ EVO: Single use sterile kit for Ø3.5 mm chamfered head screws

Surgical technique

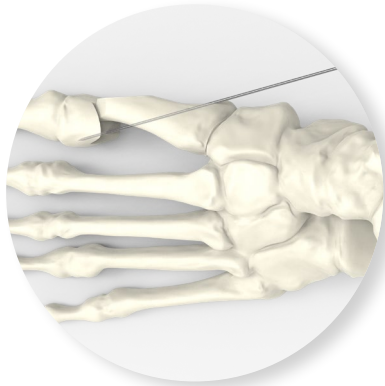

1. Insert the Ø1.4 mm pin to maintain the correction.

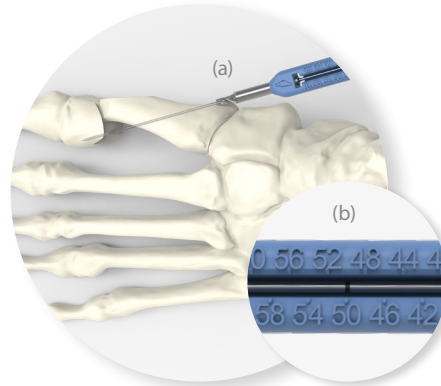

2. Slide the 3 in 1 instrument along the Ø1.4 mm pin until the cortex is reached (a). With the measuring gauge part of this instrument, read the insertion depth using the marking on the pin (b).

NB: At this stage, the pin can be inserted deeper in order to prevent its removal during the drilling step.

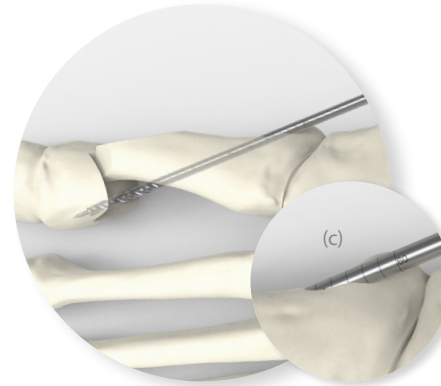

3. Drill to the desired depth. The drilling depth can be checked using the markings on the drill bit (c).

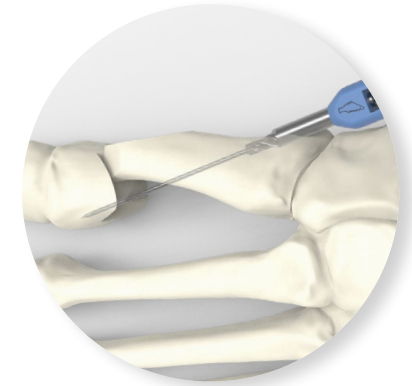

4. To ease the screw insertion, widen the first cortex using the countersink part of the 3 in 1 instrument.

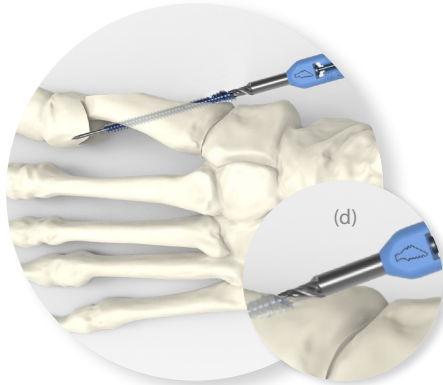

5. Select the appropriate screw length and insert the screw along the pin using the screwdriver part of the 3 in 1 instrument until the reduction is achieved. Then, remove the pin.

NB: During the screwing step, pay particular attention to the positioning of the screwdriver in the screw head, to ease the control that the screw head is flush to the bone once screwed in (d).

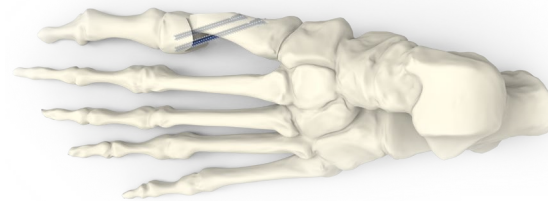

FINAL RESULT

Complete the construct by inserting a second screw following steps 1 to 5.

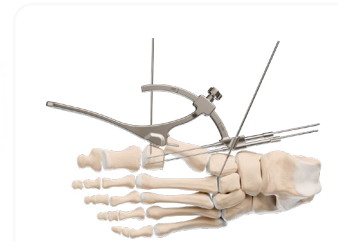

NB: This surgical technique can be associated with the use of hallux valgus targeting guide. Please refer to the G-HALVA brochure for more information.

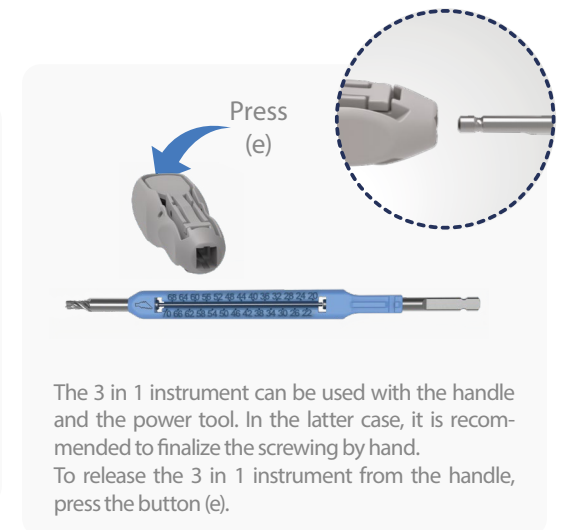

The 3 in 1 instrument can be used with the handle and the power tool. In the latter case, it is recommended to finalize the screwing by hand. To release the 3 in 1 instrument from the handle, press the button (e).